

Private Buildings
Open Carry Allowed – Concealed Carry Prohibited
Proposed Signage Adopted by the Kansas Attorney General
Effective July 1, 2014

PRINTING INSTRUCTIONS

To ensure that the graphic prints at the size required by the regulation (6” diameter), in the PDF print dialog window, be sure that **“Page Scaling”** is set to **“None.”**

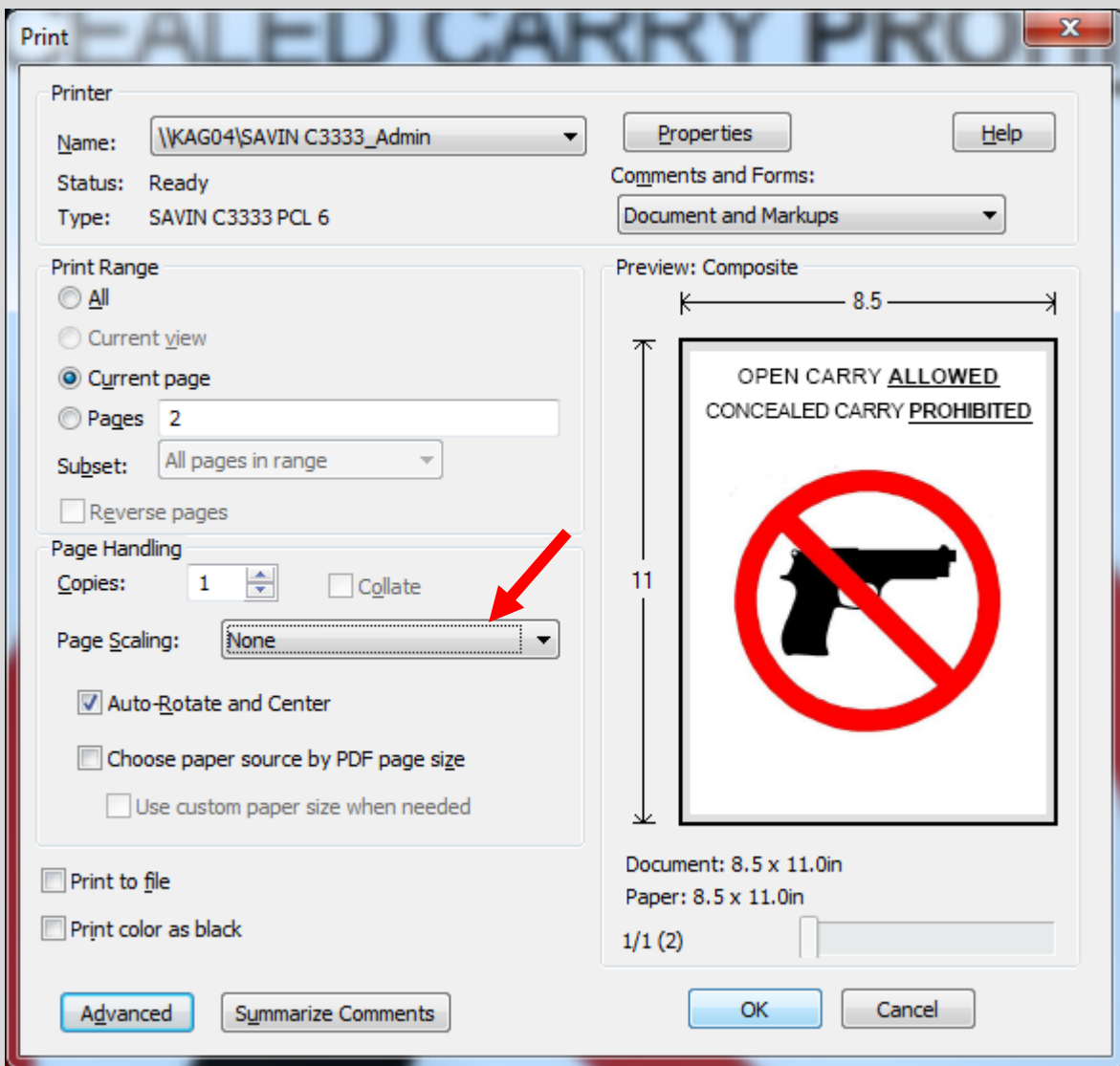

OPEN CARRY ALLOWED

CONCEALED CARRY PROHIBITED

